

Technical Bulletin



| | | | |
|-----------------|--|--------------------------------------|--------------------|
| NP01 | TB0019-2016 | Élan Motorsports Technologies | |
| From: | Robert Lindsey – Project Engineer, NP01 | | |
| Subject: | Endurance Rear Lower Wishbone | Date: | 9 Sept 2016 |

Attention all Élan NP01 customers:

Elan is now offering an “Endurance” Rear Lower Wishbone. Similar to the billet upright, this component is designed to stand up to more abuse than the standard component.

This wishbone should be used by any team operating on non-DOT tires.

The Endurance Wishbone yields an increase of 190% in load capacity and is 100% interchangeable with the standard part.

Endurance Wishbones, NP01-20-047/048 (LH/RH) will be approx. ~\$550 each (\$1100 for a pair) with pricing confirmed upon initial batch size based on orders placed. Orders may be placed with Bo White at Carl Haas Auto.

Please note that this part is not superseding the standard component in the base car. This part WILL BE LEGAL for spec series competition.

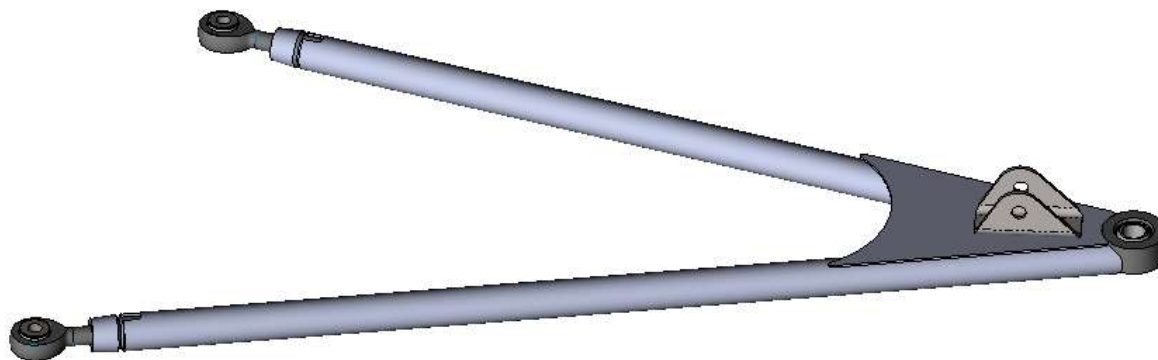

Please direct questions Brandon White – Project Coordinator, Elan Motorsports - bwhite@elangroup.com
Parts orders should be placed with Bo White – NP Sales Rep, Carl Haas Auto – haasautorw@aol.com